

HULALA

HOME

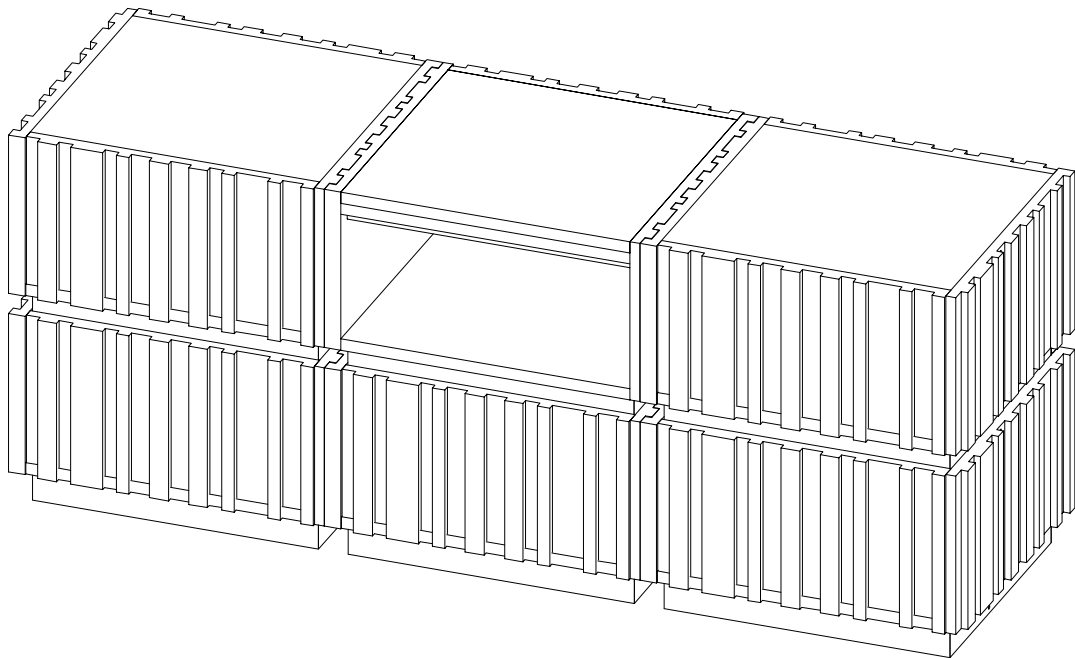

ITEM NO. MCUK002

Thank You For Choosing Our Furniture

- ▀ If you have any questions or concerns,
don't hesitate to reach out to us. ▴

Contact us: +1(833)324-2464
Email: hello@hulalahome.com

NOTE:





This brochure contains
IMPORTANT safety info.
Please read and keep it
for future reference.

MAINTENANCE AND WARNINGS



Before You Start

Please follow the steps below:



-  Check the packaging for any damage, deformation, or water stains. If there is significant damage, please contact us promptly.
-  Open the packaging and confirm that the panels, hardware, screws, etc are complete.
-  Please read the installation instructions carefully to understand the installation steps and precautions to ensure proper installation.
-  Clean the installation area in advance and ensure the ground is level and there is enough space to avoid damaging the furniture or making installation difficult.
-  Lay a protective mat on the ground to prevent scratching the floor during installation.

After-Sales Service

- If you encounter any issues or need technical support during use, please contact our after-sales team. We offer long-term maintenance and warranty services.





Precautions

-  This product is for indoor use only. Do not expose it to outdoor elements or high-humidity environments.
-  Keep the cabinet away from high heat or open flames to prevent fire hazards.
-  Do not allow children to climb on the product, as this may cause tipping and result in personal injury.



Safety Warnings

-  If you notice any loose or damaged parts, stop using the product immediately and contact customer service.
-  Do not attempt to disassemble or replace any components yourself, as this may affect the stability and safety of the product.

Daily Maintenance

- Regularly clean the surface of the sofa with a soft cloth to prevent dust accumulation.

Do not use cleaning agents containing acids, alkalis, or corrosive substances, as they may damage the surface. It is recommended to use neutral cleaning agents or specialized furniture cleaners
- Avoid exposing furniture to humid environments for extended periods to prevent swelling or deformation of the boards. Use a dehumidifier or desiccant during humid weather.
- Avoid direct contact of furniture with water. If water is accidentally spilled, wipe it dry immediately.
- Avoid placing excessively heavy objects on the furniture: ensure the weight is within a reasonable load-bearing range.
- Avoid using sharp or rough items on the furniture surface to prevent scratches. Handle items gently when moving them

Module list

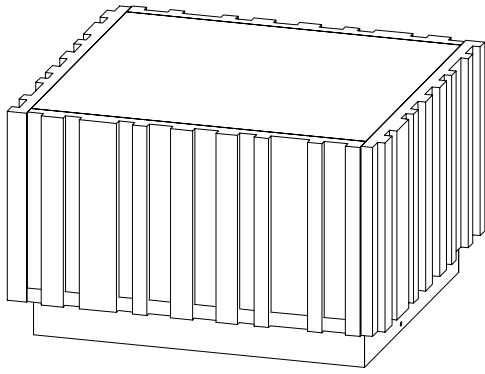

Module 1

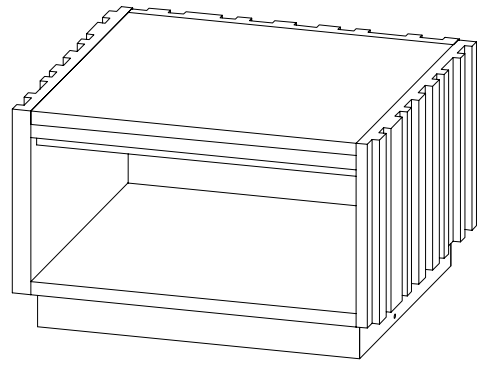

Module 2

Hardware List

1

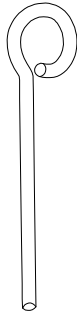

Handle Bolt x1

2

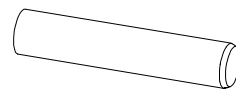

Pin
Ø6*30MM x3

The hardware pack is placed in the module cabinet.

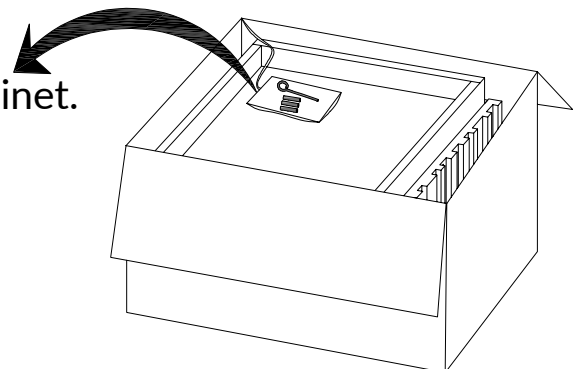

Functions Introduction

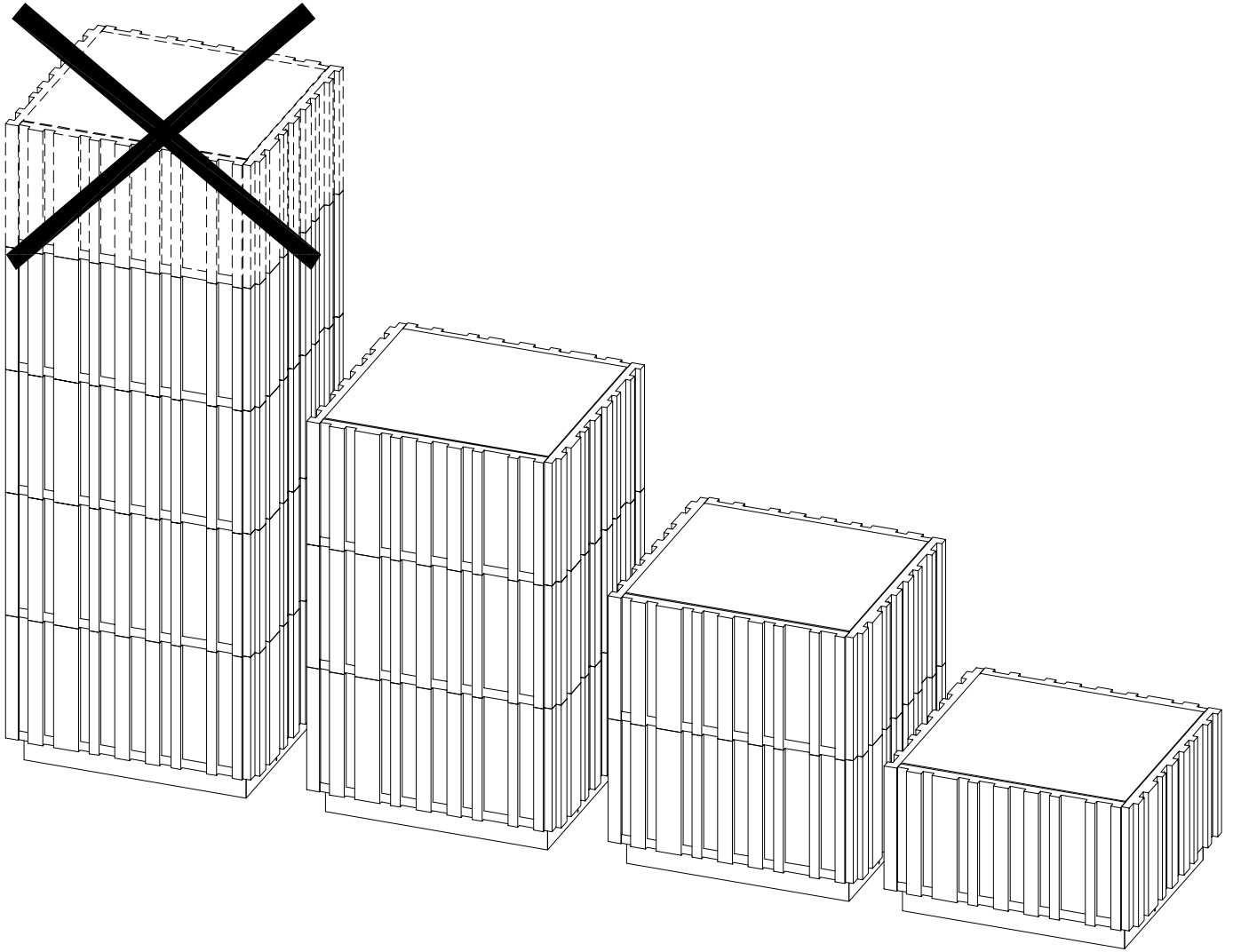
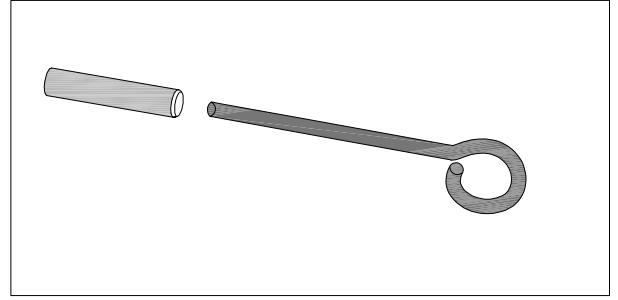

Installation:
10 minutes.



One Person

Functions Introduction

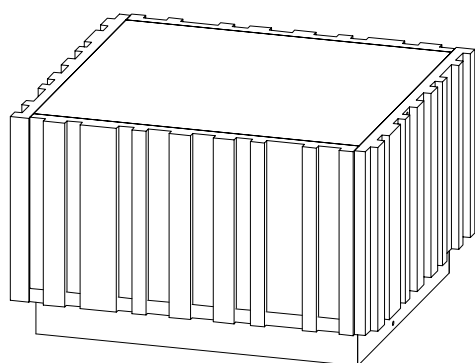
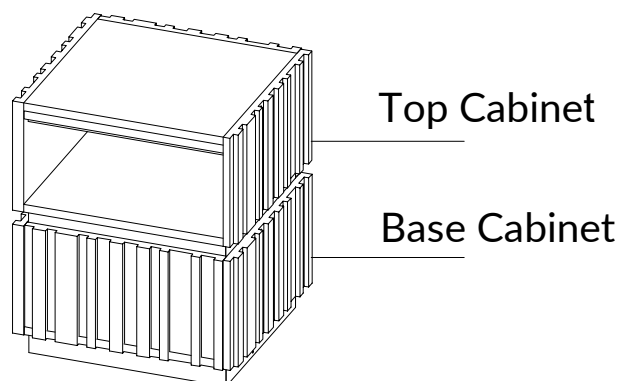
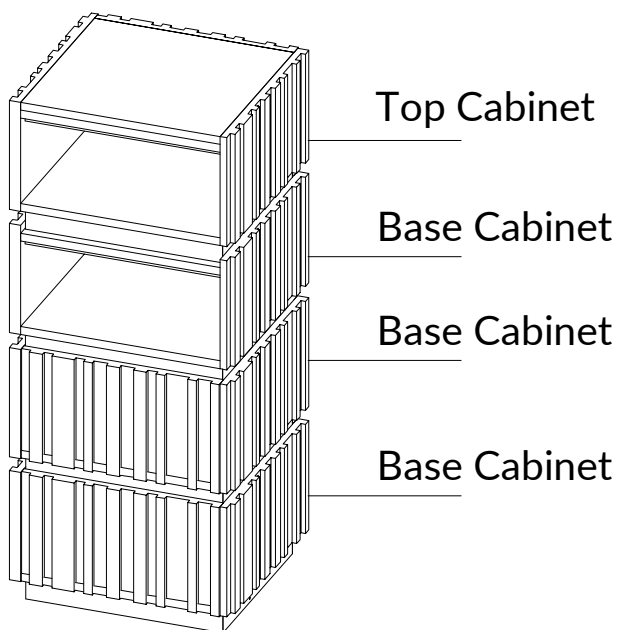

Top Cabinet

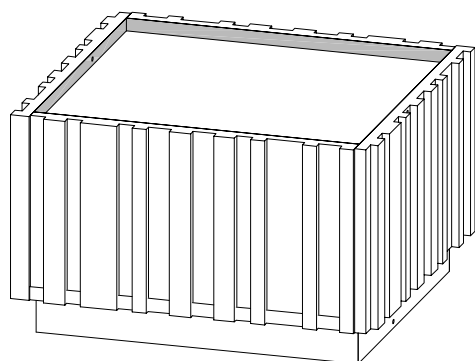
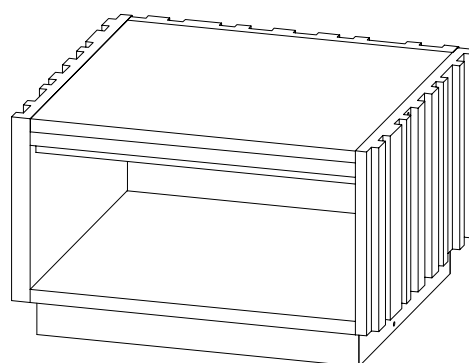

Base Cabinet

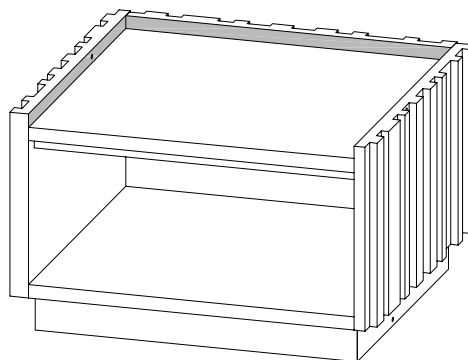

You can see How to transform the Top Cabinet to Base Cabinet in Step1.

Step 1

How to transform the Top Cabinet to Base Cabinet.

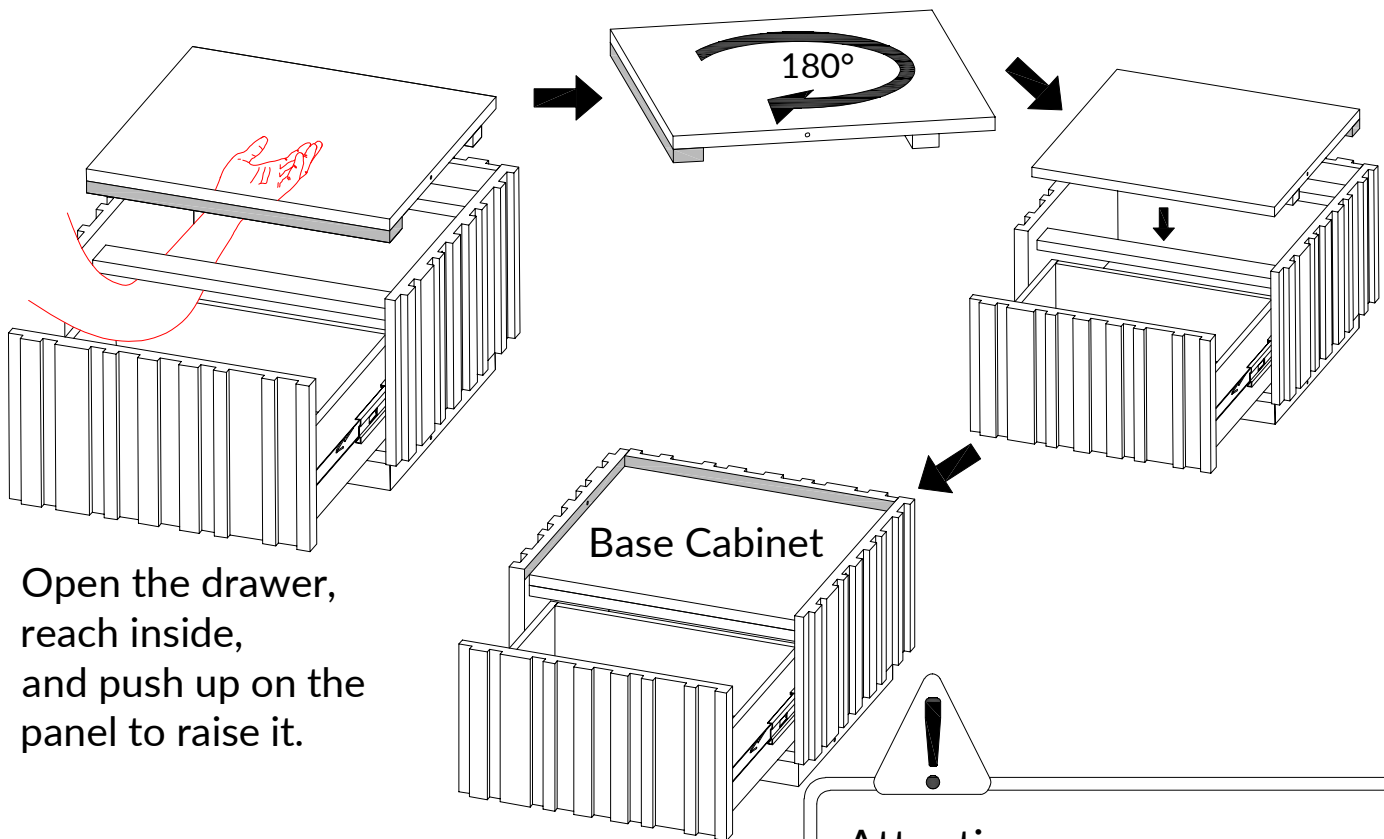

Open the drawer,
reach inside,
and push up on the
panel to raise it.

Attention:
Be careful to avoid scratching
your hands.

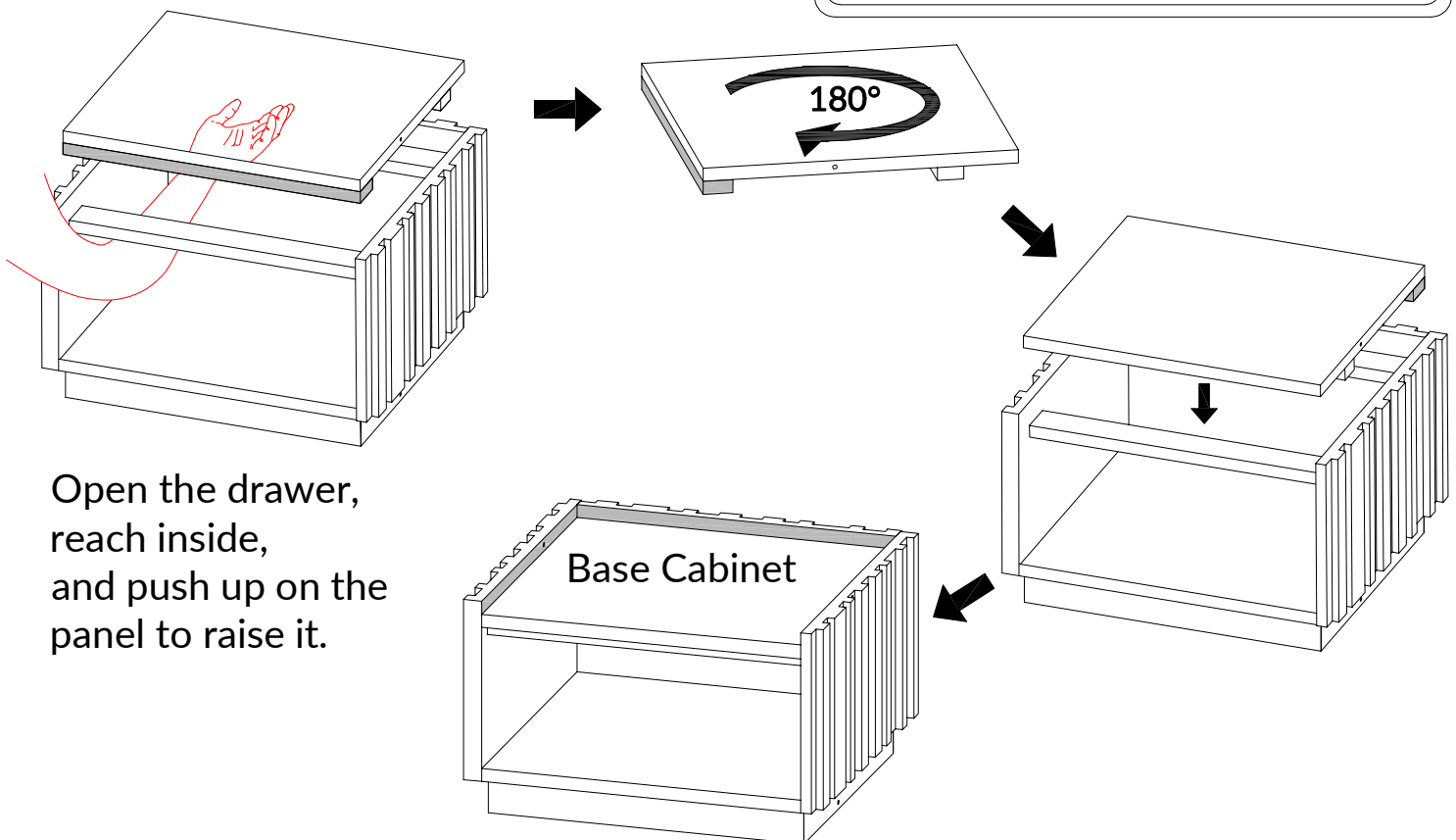



Open the drawer,
reach inside,
and push up on the
panel to raise it.

Step 2

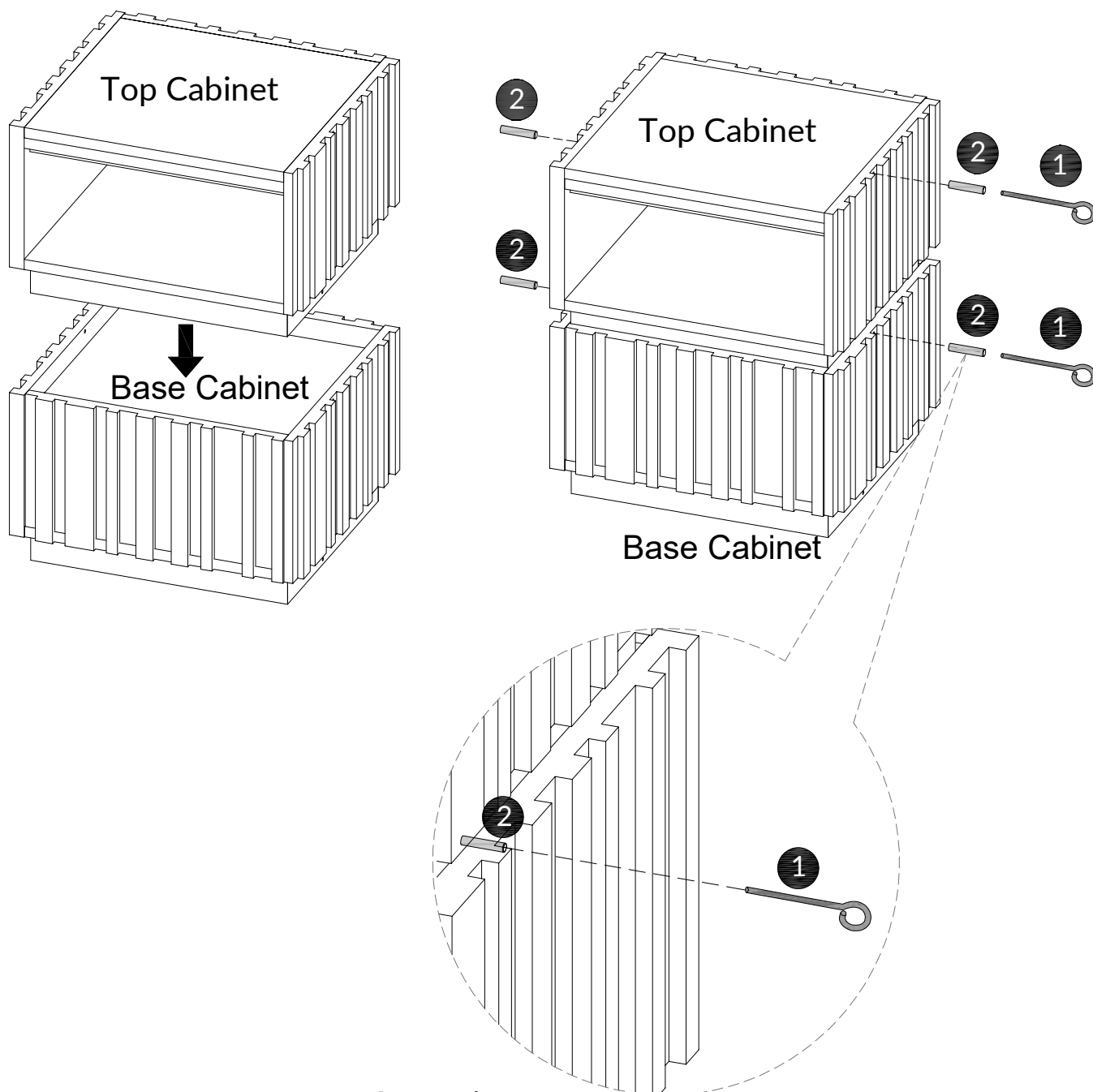
Place the top cabinet on the bottom cabinet and insert the pins ② into the holes to secure it. At the same time, fix the top cabinet panel in the same way.



Attention:
Do not insert the pin beyond the surface of the outer panel.

① x1	② x4
	
	Ø6*30MM

Step 3

You can use the previous assembly method as a reference to create other configurations.

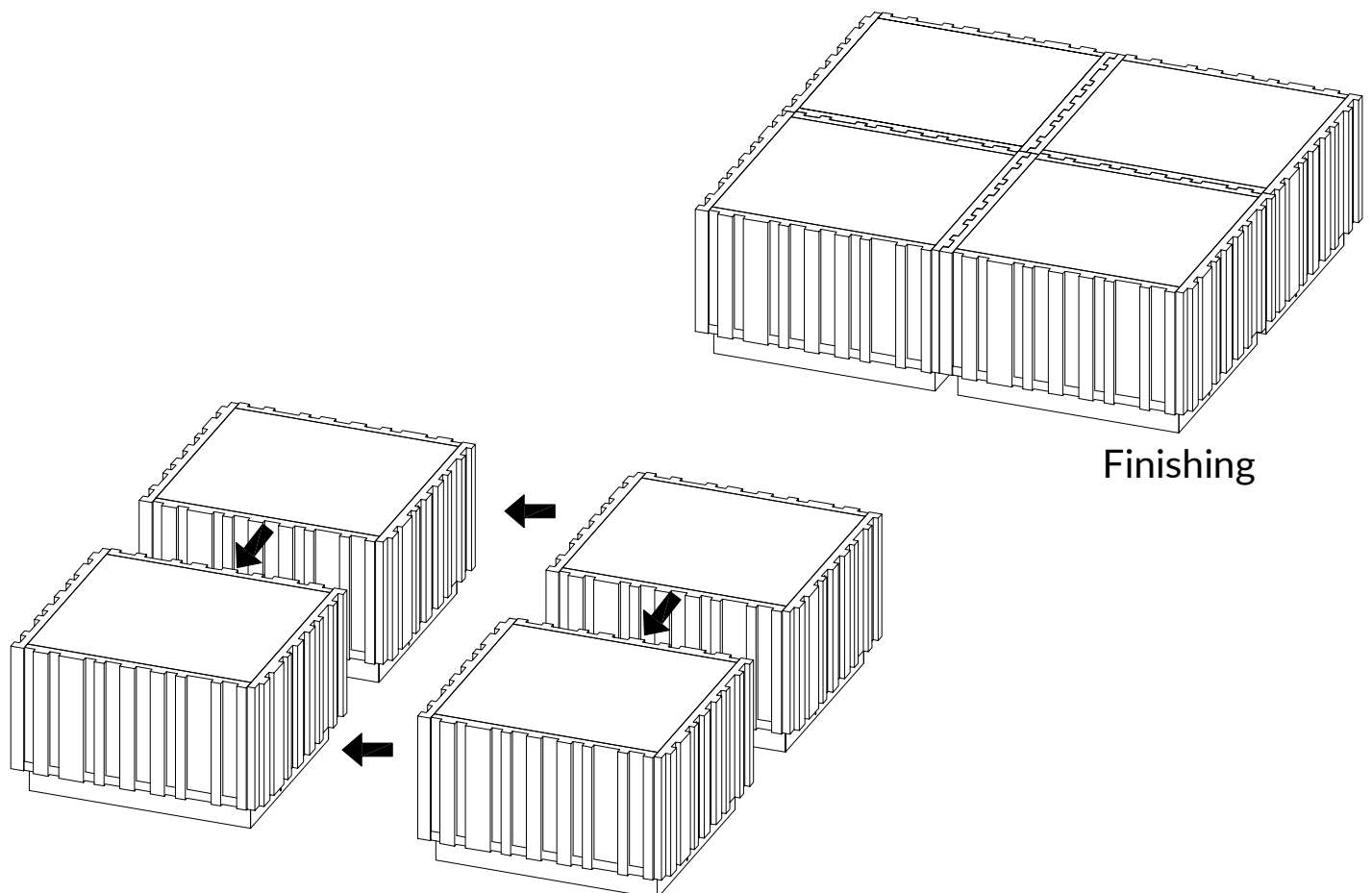
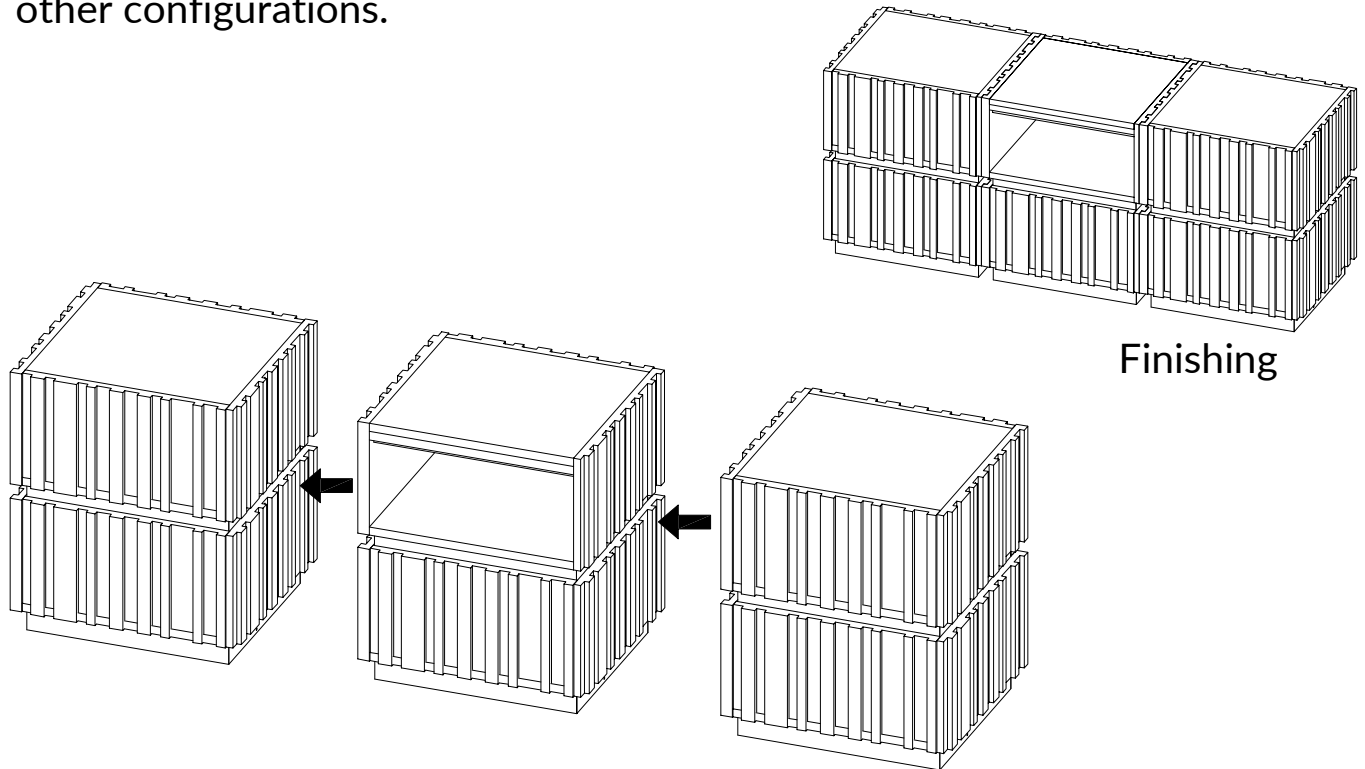

Disassembly Instructions

For disassembly instructions, please see the diagram below.

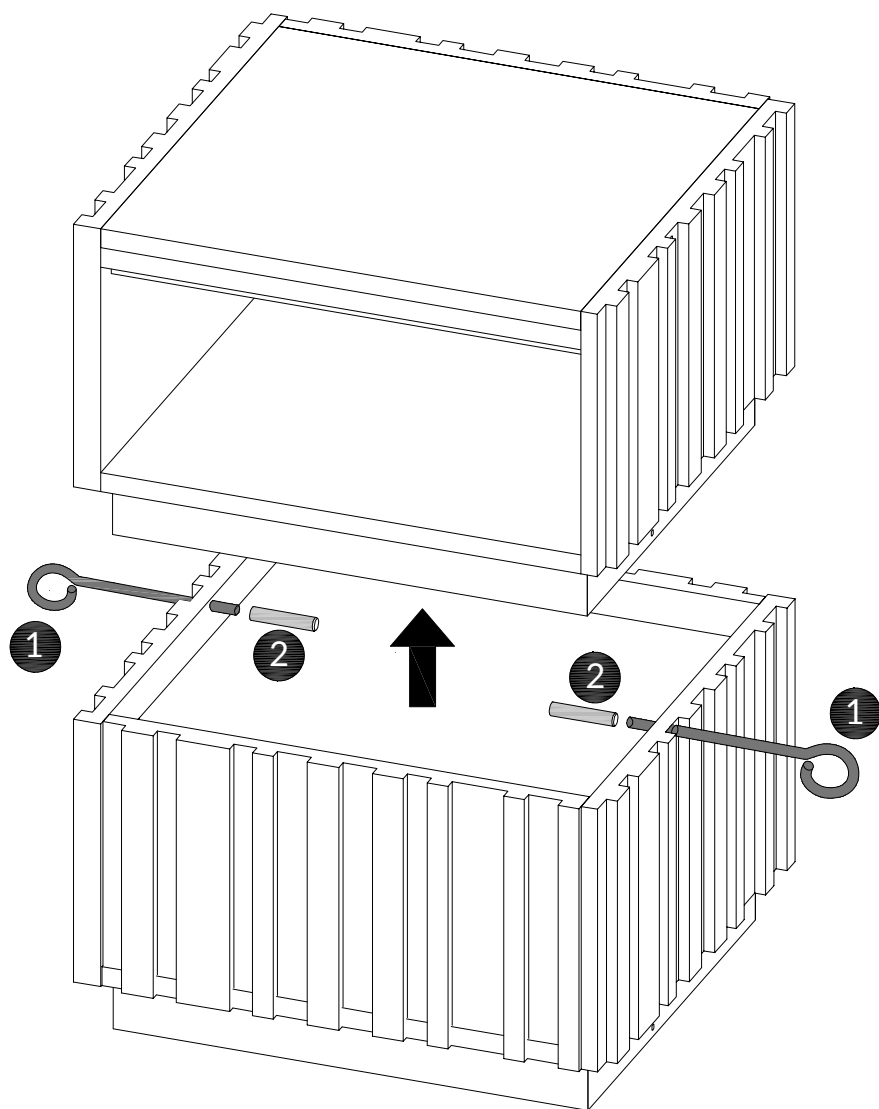

Push the Pin ② in by the Handle Bolt ① until it bottoms out, then remove the cabinet.

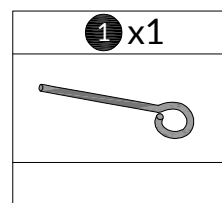

WARNING

Install Anti-tip device 3 and tighten screw 5 with screwdriver .

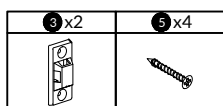
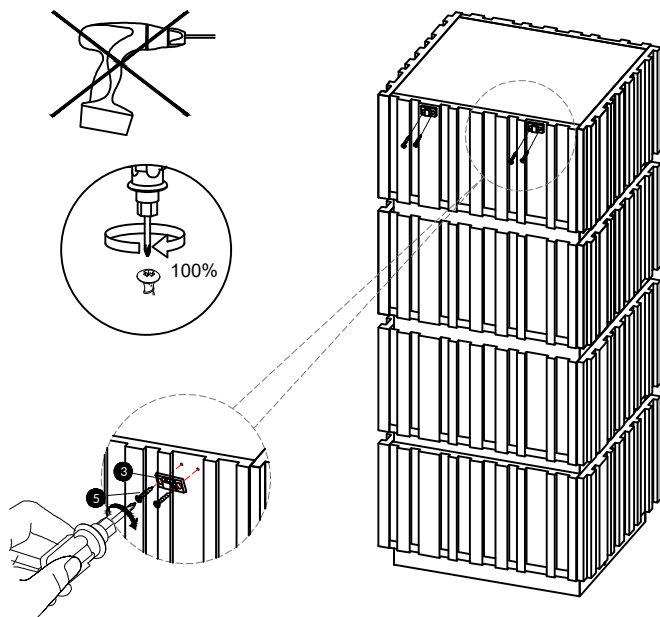

1

WARNING

Install Anti-tip device 3 to the wall in this step.

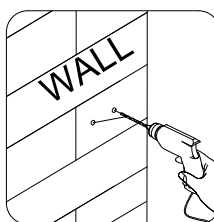
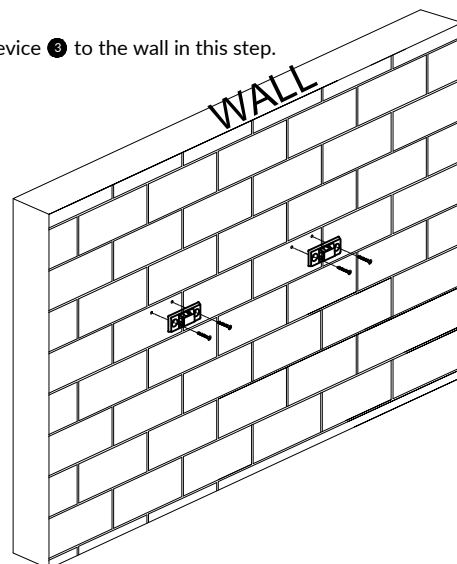

1. Drill a hole in the wall with an electric drill.

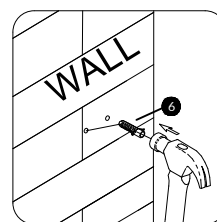

2. Tap the plastic wall anchor into the hole with a hammer.

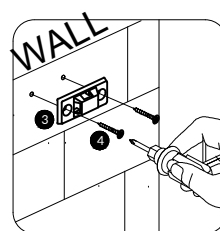

3. Secure the Anti-tip device 3 to the wall with screws 4.

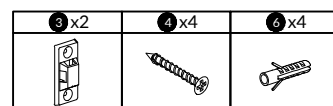

2

WARNING

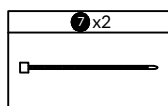
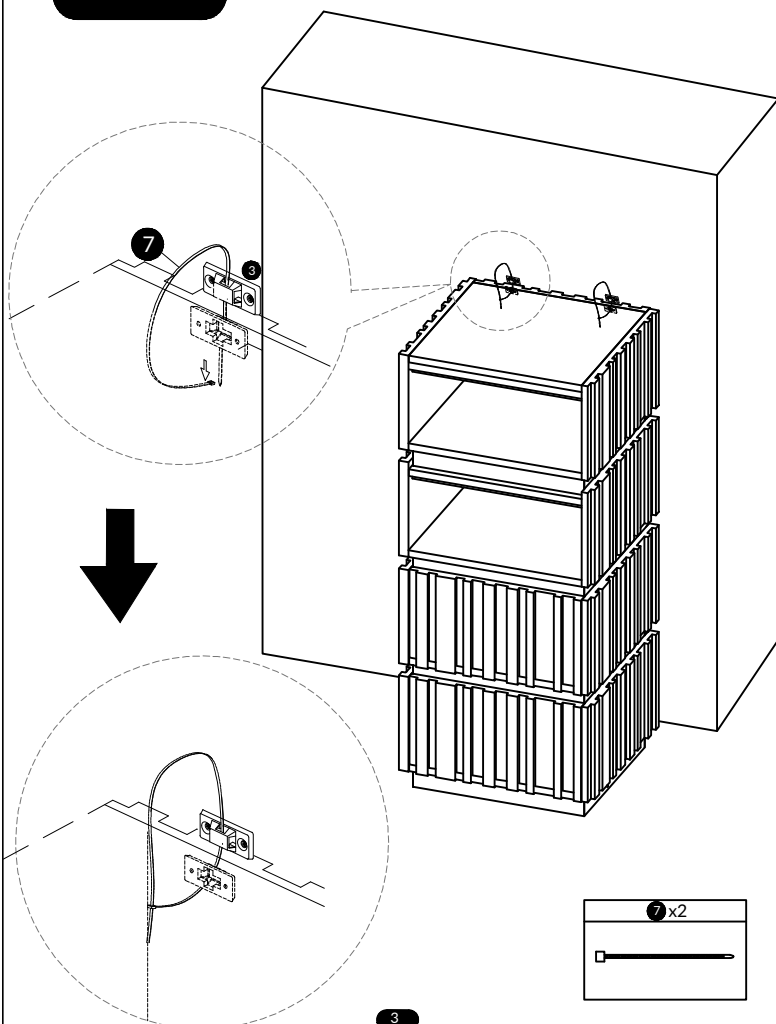

3

WARNING

Children have died from furniture tipover.

To reduce the risk of furniture tipover:

- ALWAYS install Anti-tip device provided.
- For use with televisions weighing 35 lb or less. Use with heavier televisions may result in instability causing tip-over resulting in death or serious injury.
- NEVER allow children to stand, climb or hang on drawers, doors, or shelves.
- NEVER open more than one drawer at a time.
- Place heaviest items in the lowest drawers.



4

WARRANTY

- We strive to offer quality products, and we also try our best to satisfy every customer who orders from us with products or services as needed.
- Replacement parts can be purchased from our company if available.
- For returns, please check the return policy with the retailer or marketplace where you purchased the item.

Are you having difficulty

With assembly? Missing parts?
Please send an email with your order No. to
hello@hulalahome.com

We appreciate your purchase.
Brighten your life with our furniture!